



Express 250 and CPF50

Electric Vehicle Charging Stations

Re-branding Instructions

*Tamper-proof T25 screwdriver required

CPE250 ~ 20 mins

CPF50 ~ 2 mins

Two technicians recommended



1. ENSURE POWER TO THE UNIT IS OFF BEFORE BEGINNING

2. Use a T25 Torx driver to loosen the two captive screws on the bottom edge of the area light bar.



3. Disconnect the power cable from the LED display



4. Gently push the LED screen upwards so that the mounting brackets are no longer secured, and disconnect the wires shown

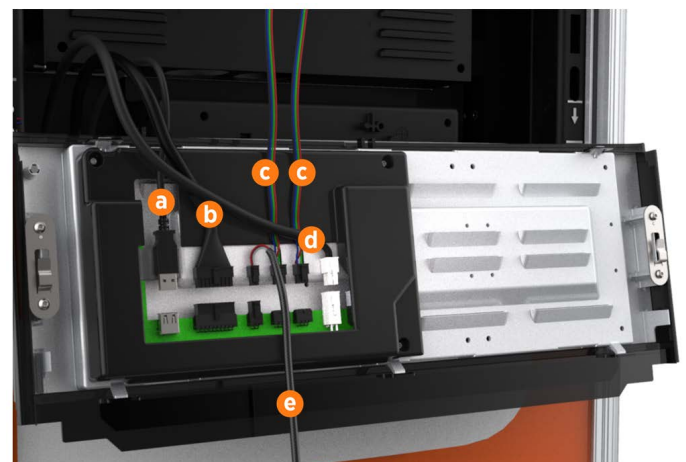

5. Gently lift the front panel until the mounting brackets are loose, and set the panel to the side.

6. The orange ChargePoint signing is held to the panel using a weak adhesive, gently remove and replace the sign with the rebranding replacement



7. Use a T25 Torx driver to unscrew the M5 screws and washers connecting the touchscreen ground strap to the frame (d).

8. Loosen the retention knobs (a), allowing the touchscreen beam (b) to slide up vertically. Re-tighten at the highest position

9. Gently tilt the bottom of the touchscreen up to allow the removal of the middle vent below

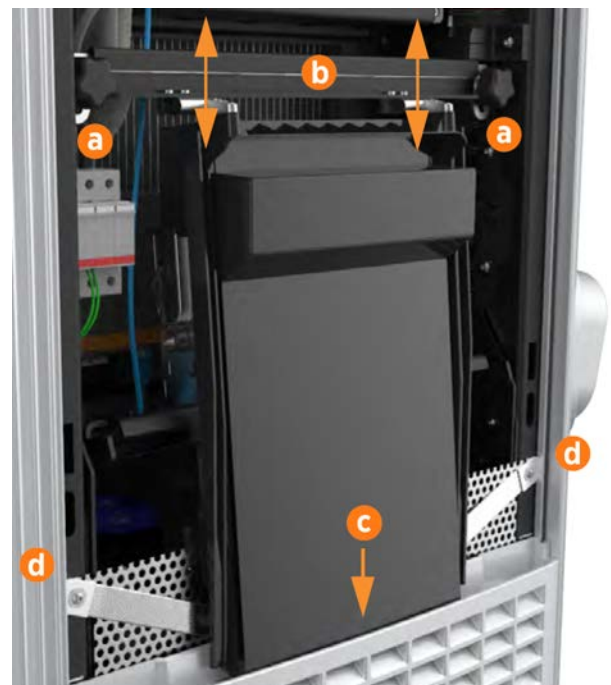

10. Lift the middle vent up, and set aside



11. You should now be able to remove the orange ChargePoint sign from the lower portion of the unit, and slide the new one into place.



12. Align the guide tabs on the middle vent panel to the corresponding slots on the Express 250's frame. Ensure the lower sign is correctly captured as you carefully push the middle panel down until it is fully seated.

13. With hand pressure, swing the touchscreen down. Loosen both retention knobs (a), allowing the touchscreen beam (b) to slide up vertically. Re-tighten the knobs at the highest position.

14. Tilt the bottom of the touchscreen inside the slot in the middle vent panel, aligning the notch in the center of the bottom edge (c) to the guide ridge inside the panel slot.

15. Keeping pressure on the edge of the touchscreen to properly seat it inside the panel, loosen the knobs to lower the screen again. Re-tighten the knobs to secure it.

16. Use a T25 Torx driver to re-secure the M5 washers and screws to the frame (d). Torque to 4 Nm (35 in-lbs)



17. Using two hands, align the guide tabs on the front upper panel with the corresponding slots. While pushing the panel into place, push the bottom edge and its sign inward to position them inside the groove in the middle vent panel and engage the edge of the sign.



18. Using two hands, align the guide tabs on the front upper panel with the corresponding slots. While pushing the panel into place, push the bottom edge and its sign inward to position them inside the groove in the middle vent panel and engage the edge of the sign.

19. Carefully push the panel down until it is firmly seated



20. While holding the LED display near the opening at the top of the Express 250, connect its five cables to their corresponding connectors on the back of the display (each connector is keyed to fit only into its matching port):

- a. Communications cable (USB-A)
- b. Holster light cable
- c. Area light cable (x2)
- d. Power cable (24 V)

****Leave the area light bar cable (e) loose.**

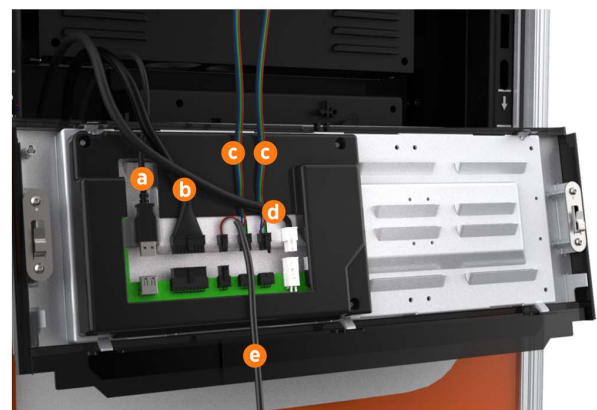

21. Angle the top edge of the LED display under the light bar on the Express 250. Starting at the top, align and slide the LED display guide tabs into the corresponding slots. Ensure the lower sign is correctly captured by the bottom edge of the LED display. Push the bottom into place until firmly seated.

Note: Keep the area light cable routed out the top of the display, and then reconnect.



22. Ensure the gasket on each end of the new area light bar is properly seated around the plastic tab.



23. Use a T25 Torx driver to tighten the two captive screws on the bottom edge of the area light bar.

24. Reconnect power, and then give the unit about 5 minutes to connect to the ChargePoint network. It will run a self-assessment, and once done the LED panel should display "Available." If it doesn't, contact ChargePoint support at 1-888-758-4389 and ask them to see if there are any issues on their end.



CPF50

1. Remove the plug from the holster
2. Locate the tabs on the bottom of the face plate (shown below), and pull to pop the face plate off.
3. Slide the new face plate over the holster, and push down to secure tightly. Make sure that each corner of the face plate is securely fastened.
4. Return plug to holster.

